



The KnowWhere CAMPUS SAFETY SYSTEM™

THE NEW INDUSTRY STANDARD IN SECURITY TECHNOLOGY

THE
KnowWhere
PRINCIPLES

1. Safety is a human right
2. Schools are relying on outdated security methods
3. Kids deserve to be kids, not the first line of defense
4. Schools shouldn't have to choose between security and textbooks
5. Knowing is the foundation of safety



*Offices in Chicago, IL, Provo, UT, and
Parkland, FL*

*Over 10,000 KW-PODS searching for threats
24/7*

*Partnered with the top law firms and school
safety experts in the country*

Where we are

TODAY

FORGET EVERYTHING YOU KNOW ABOUT SECURITY.

We're filling the gaps

The point of a security system is to protect your assets. The most important asset that school administrators are charged with protecting is the students. Our question to traditional security is, **how can you protect people if you don't know where they are?** The first question asked by dispatch after being notified of a threat is "where are you?". However, many first responders that are called to intervene in a crisis are unfamiliar with school campuses, the layouts of the building, and even the room numbering system. Even if first responders are familiar with the school, human reported data in a crisis can be inaccurate, conflicting, and unusable by first responders.

This lack of information creates confusion in crisis response and increases the amount of time it takes for first responders to intervene in a crisis.

Oftentimes, a crisis can be over in seconds. There are very few historical examples of crisis situations in schools where law enforcement has been able to intervene in a crisis before it is over. This puts the burden of immediate response on administrators, teachers, and students. With limited information on where a threat is, what it looks like, and who is in the most immediate area of the threat, it is almost impossible for people experiencing the crisis to make informed decisions on how to respond. The current response capabilities of schools put students, teachers, and administrators at risk because of this lack of information.

KnowWhere OVERVIEW

The KnowWhere Campus Safety System is a hardware and software solution for school administrators and first responders who are responsible for school safety concerns and accountable for students on campus. Our product is the first of its kind to integrate indoor geospatial information with threat sensors and imaging to give schools the ability to know where students are on campus, identify threats early, respond immediately, and provide actionable information to first responders in an emergency: all in real-time.

We developed the KnowWhere Campus System in response to the information gap experienced by administrators and first responders. With the KnowWhere System, administrators and first responders now have the information they need to make decisions in a crisis situation with speed and precision.

The FBI recommends that in an active shooter situation we follow the "RUN, HIDE, FIGHT" rule. Kids shouldn't be the first line of defense in these situations. With traditional security, teachers and students are making this decision with no information. With the KnowWhere System, now we know where to run and where to hide, and first responders know who to fight.



KW-PODS, the hardware in the system, is installed throughout the entire campus, inside and outside, so there is total coverage of the property.

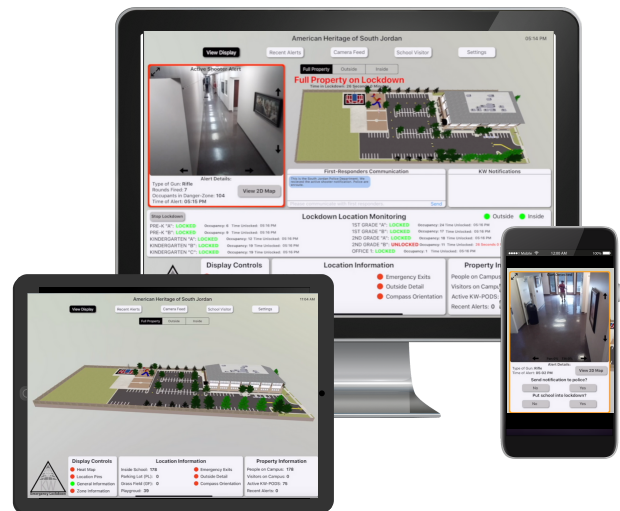

KW-CONTROL, the software in the system, is accessible on all devices for unlimited users. In the event of a crisis, first responders have access to the system so that everyone has actionable information.

RUN

HIDE

FIGHT

THE KnowWhere CAMPUS SAFETY SYSTEM

All the tools you need under one roof
DRIVEN BY ARTIFICIAL INTELLIGENCE



COMMUNICATION

2-Way Communication in every room and hallway



ASSET MANAGEMENT

Know exactly how many people are in each room and area



THREAT DETECTION

Detects weapons, fights, vandalism, and more



DISPATCH

Integrates directly with dispatch centers for first responders



INTRUSION

After hours monitoring, motion sensing, burglar alarms



PERIMETER

Secure perimeters inside and outside and get alerts if needed



ACCESS CONTROL

Integrates with and automates existing access control



LOCKDOWN

Complete crisis management tool for admin and first responders



"PANIC BUTTONS"

Panic buttons in every room and area, inside and outside

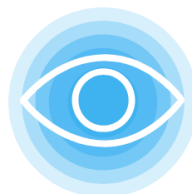

VIDEO

HD video of any incident anywhere on campus



VISITORS

Advanced visitor and volunteer management



IT DOESN'T MATTER HOW GOOD THE SCHOOL OR EDUCATION IS

IF KIDS AREN'T COMING HOME AT THE END OF THE DAY

The point of a security system is to keep people safe. How can you keep something safe if you don't know where it is?

With the KnowWhere Campus Safety System we can immediately know how many people are in each room and area of the campus, inside and outside, in real-time. We do this without using personal identifying information and without relying on human variables, such as students carrying phones or swiping cards.

This gives administrators a greater awareness of where their students are on campus at any given time. In the event of an emergency they'll know who is at the greatest risk based on proximity to the threat.

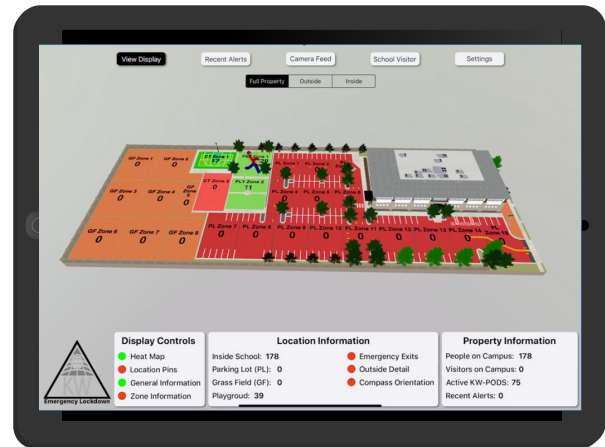

EXTERIOR VIEW

Indoor/ Outdoor Geospatial Information

USE CASES

- Asset Management
- Virtual Security Perimeters
- Location Monitoring
- Event Monitoring
- After-Hours Monitoring

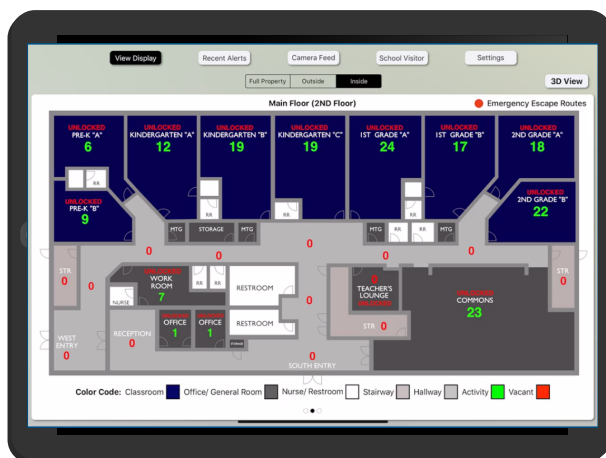

INTERIOR VIEW

WHEN SECONDS COUNT MINUTES DON'T MATTER

Early warning is necessary in order to intervene before a situation escalates. The system is constantly searching for threats on campus and allows administrators to visually verify the threat from KW-CONTROL and take action in seconds.

Threat Detection

- Weapons
 - Guns, Knives, Dangerous Objects
 - Concealed carry guns
- Gunshots
 - Number of shots
 - Type of Weapon
- Airborne Contaminants
- Fire (Before smoke is generated)
- Water Leaks
- Vandalism
- Fights
- Visitors and Volunteers
- Vaping

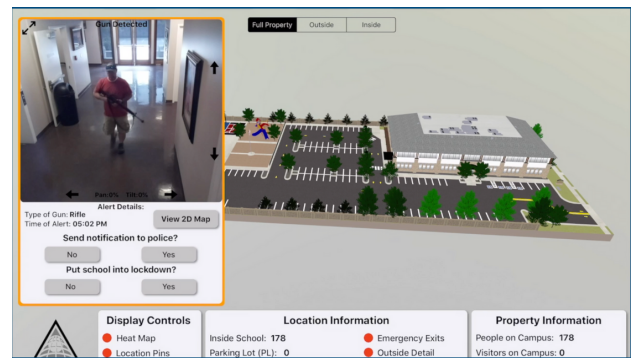

VISUAL THREAT VERIFICATION

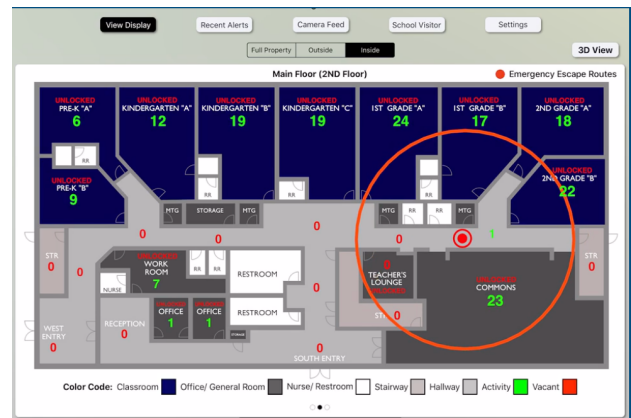

THREAT TRACKING

NEW FEATURE- INFECTION IDENTIFICATION AND MANAGEMENT

- Identify Infection (fever)
- Tracks rate and spread of infection
- Identifies infection hotspots
- Checks for correct physical distancing

We're committed to making sure our system can handle any threat. That's why updates are always included with your subscription.

UNKNOWN VARIABLES

Visitor and Volunteer Management

- Check-In
 - Scans ID or Driver's License
- Secure
 - Checks sex offender registry, open warrants for arrest, and past criminal history of violent offenses
 - Keep a list of pre-approved visitors
 - Keep a list of restricted guests
- Track
 - Track the visitor as they move throughout the school
 - Set time and location based alert parameters
 - Get an alert if they remove their visitor pass



BECAUSE WE KNOW WHERE, EVERYTHING ELSE MAKES SENSE

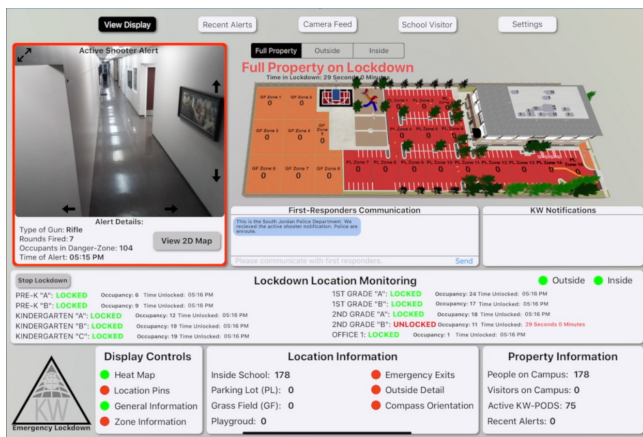

Automatic and Manual

- Threat is detected and tracked
- Visual and Audio Alert and Prompts
- Lockdown Verification
- Police are notified and real-time information is shared
- Determines injury priority areas
- Remotely check the status of each room and area of the school
- Access and alter emergency evacuation routes
- Evacuate the school with visual and audio prompts and routes

First responders are able to access the system in the event of a crisis from their car consoles and dispatch. They arrive on campus knowing what the threat is, where the threat is, who is around the threat, and the best way to intervene.

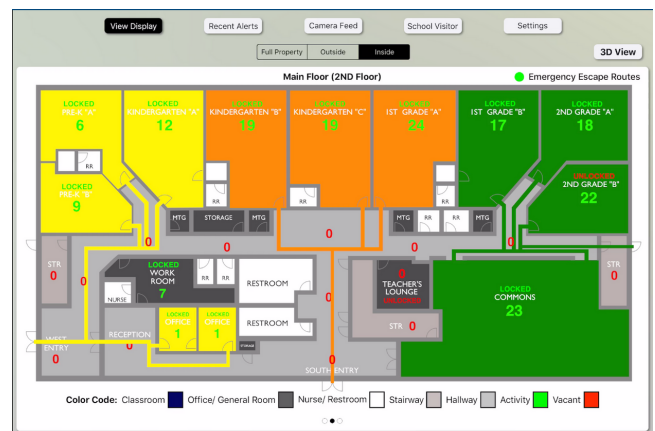
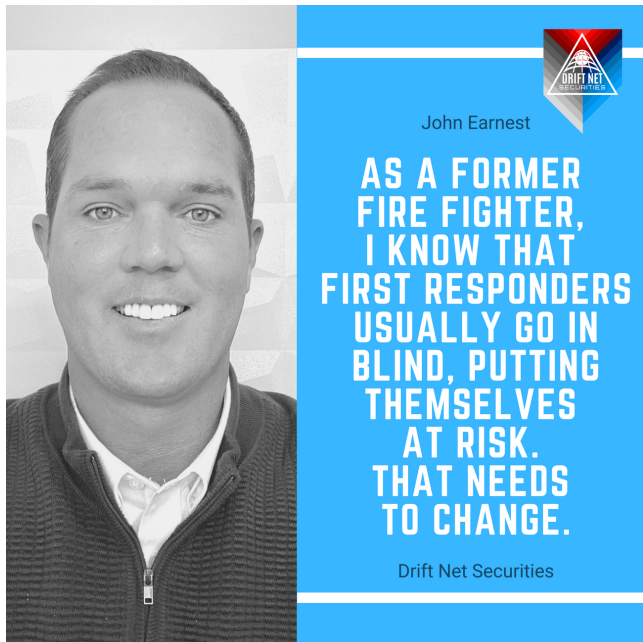

Made in the USA | Manufactured in House

Full district implementations at less than 10X the cost of traditional cameras



FUNCTIONALITY

The highest performing product, with the most abilities

AFFORDABILITY

Affordable to any school district so that your budget can do more

SUSTAINABILITY

Upgrades are always free so that you always have the best

Endorsed by

RYAN PETTY

Father of Parkland Shooting Victim, School Safety Expert, Florida State BOE, our CPO

"Protecting our students, teachers and staff at school is the responsibility of every school district and school administrator. Nothing our schools achieve and no matter how great our academics and educational programs may be, if our students and teachers don't return home safely.

I endorse the KnowWhere Campus Safety System and know it can improve the response times for active assailant incidents. It also provides a deterrent effect and will enhance school safety by reducing the response times to the threats faced by our schools."

COMPREHENSIVE TOOL KIT

The KnowWhere System keeps everything under one roof so that it works together and is easy and efficient to access and use. Even better, all of those tools are contextualized so that information makes sense and is usable.

SMART AND REAL-TIME

The system can be used manually or automatically. This makes sure that in the case of a crisis, humans can do what they do best and the KnowWhere System reduces error and picks up the slack.

INFORMATION IS ACTIONABLE

We put information in the hands of the people that need it the most, immediately. KnowWhere leaves no one in the dark; whether it's students, faculty, or first responders, everyone knows where, what, and who the threat is.

LIMITED RESOURCE IMPACT

We know resources are limited. That's why our system limits the impact. We don't drill holes or run wires to install. We don't use your servers or your wired internet.



YOUR KNOWN DEFENSE FOR THE UNKNOWN OFFENSE

It's your responsibility to

KEEP PEOPLE SAFE

It's our job to help you make that happen

CONTACT US

844- DRFT NET

info@driftnet.net

TALK TO A FOUNDER

Brigitte Coles, VP

773- 469-6554

brigittec@driftnet.net

www.driftnetsecurities.com